

<p style="text-align: center;">ELEUTHERA 60 STANDARD INVENTORY</p>
--

GENERAL CHARACTERISTICS:

LOA : 18.28 m
Bmax : 8.57 m
Draft : 1.45 m
Clearance : 24 m
Lightweight displacement of standard boat : 18 000 kg
Displacement under maximum load : 24 000 kg

Sail area :

- Genoa : 70 m² (approx.)
- Mainsail : 110 m² (approx.)

Engines : 2 x 75 Hp

Tank capacity :

Fresh water : 825 L (approx.)
Fuel : 600 L (approx.)

Boat currently undergoing UE approval .

Architects : BERRET RACOUPEAU YACHT DESIGN

INTERIOR LAYOUT :**General :**

- ?? Lining : Alcantara
- ?? Douka woodwork
- ?? Interior flooring : wood effect laminate
- ?? Leather bench seating
- ?? Bultex foam mattresses

SALOON LAYOUT :**General :**

- ?? Saloon accessed through double laminated glass sliding door
- ?? Panoramic view through picture windows and aft-facing portholes
- ?? Ventilation via 2 big front opening hatches + 2 deck hatches on the roof
- ?? Permanent ventilation by air intake under the cap

Galley :

- ?? U-shaped galley with full synthetic resin working top
- ?? 2 stainless steel sinks, 300x300mm approx.
- ?? Synthetic resin draining board around both sinks
- ?? 1 vertically-accessed bin, bags removed from separate door
- ?? Hot and cold pressurized water, mixer tap
- ?? Pressurized salt water
- ?? 1 stainless steel hob, 4 strong power gas burners
- ?? 1 x 54 L stainless steel strong power gas oven
- ?? 1 x 160 L stainless steel refrigerator
- ?? Lots of cupboards and drawers
- ?? Space allowed for large dishwasher (12 place settings)
- ?? Bar with synthetic resin tray
- ?? Halogen spot lighting
- ?? Ventilation via hood above cooking hob

Dining area :

- ?? 1 x 8-place bench seat, 2 seats in passageway
- ?? 1 wooden table to seat 10
- ?? 1 drawer at either end of the bench seat
- ?? Bookshelves behind the bench seat
- ?? Lots of halogen spotlights and wall lights

Saloon area :

- ?? 1 bench seat for 5 people
- ?? 1 small synthetic resin table
- ?? Bookshelves behind the bench seat

Chart table :

- ?? Wooden chart table with leather pad
- ?? Space for charts
- ?? Large panel for electrical controls and navigational instruments
- ?? Drawers under the chart table
- ?? Spinning leather chair on stainless steel pedestal
- ?? Reading light

INTERIOR LAYOUT :

MAESTRO VERSION : 1 owner's suite to port + 2 double cabins to starboard

**PORT HULL : 1 owner's suite**

Accessed through wooden door at the bottom of the companionway

Sleeping accommodation :

- ?? Double bed, 1.60 / 1.20 x 2.00 approx. with access from either side (island bed) and slatted bed base
- ?? 2 spacious drawers under the bed
- ?? 1 bedside table with shelves
- ?? Lots of cupboards above the bed
- ?? Bookcase above the bed
- ?? Ventilation via deck hatch
- ?? Blinds and mosquito netting on deck hatches
- ?? Large non-opening picture window, external view
- ?? Main lighting : 3 spotlights and 2 bedside reading lights

Saloon area :

- ?? 2-seater bench seat
- ?? Wooden desk with leather pad and space under lift-up front
- ?? Drawers under desk
- ?? Lots of cupboards and hanging space
- ?? 2 coat hooks
- ?? Ventilation via 2 deck hatches + 1 escape hatch overlooking underside of the pod
- ?? Blinds and mosquito netting on the deck hatches
- ?? Main lighting : halogen spotlights and 1 bedside reading light

Separate MARINE TOILET

- ?? Accessed through wooden door from the saloon area
- ?? Hand operated marine toilet
- ?? Pressurized hot and cold water, mixer tap
- ?? Ventilation via 1 deck hatch
- ?? Lighting : 2 waterproof spotlights

Bathroom area :

- ?? Accessed by wooden door from saloon area
- ?? Synthetic resin counter top with 2 built-in wrap-round lights and mirror
- ?? Bathroom accessories
- ?? Spacious shelving
- ?? Separate shower with hot and cold water, mixer tap
- ?? Drainage by gravity to the waste water network
- ?? Ventilation via 2 deck hatches + 1 interior non-opening sidelight in hull
- ?? Lighting : 3 waterproof spotlights

STARBOARD HULL : 2 double cabins

Access to starboard hull via staircase

Aft cabin :

- ?? Access via wooden door in the passageway
- ?? Double bed (1.60 / 1.20 x 2.00m approx.) with access from either side (island bed) and slatted bed base
- ?? 2 spacious drawers under the bed
- ?? Lots of cupboards and hanging space
- ?? 2 coat hooks
- ?? Ventilation via 2 deck hatches
- ?? Large non-opening picture window, external view
- ?? Blinds and mosquito netting on deck hatches
- ?? Main lighting : 3 spotlights and 2 bedside reading lights

Aft bathroom :

- ?? Private access through wooden door from the aft cabin
- ?? Synthetic resin counter top with built in wash basin
- ?? Hot and cold water, mixer tap, built in hand shower
- ?? Shower with drainage to waste water network
- ?? Hand-operated marine toilet
- ?? Bathroom accessories (toilet paper holder and + towel rail)
- ?? Shelving above basin with mirror
- ?? Ventilation via 1 deck hatch
- ?? Lighting : 2 watertight spotlights

Passageway :

- ?? Storage volume 250 L cooled by 1 eutectic plaque
- ?? Eutectic plaque energy supplied via 1 refrigeration system
- ?? Refrigeration volume 450 L cooled by 1 eutectic plaque
- ?? Eutectic plaque energy supplied via 1 refrigeration system 12V/220V coupled indirectly to engine
- ?? Spacious cupboards with space for 5 kg washing machine and 5 kg clothes dryer
- ?? Escape hatch overlooking underside of the pod

Fore cabin :

- ?? Accessed through wooden door in the passageway
- ?? Double bed (1.35/1.10x2.00m approx.) with slatted bed base
- ?? 2 big drawers under the bed
- ?? 1 hanging space and storage space
- ?? Ventilation via 2 deck hatches
- ?? Blinds and mosquito nets on the deck hatches
- ?? Main lighting via 2 halogen spotlights + 2 bedside reading lights

Forward bathroom :

- ?? Private access from the cabin via wooden door
- ?? Synthetic resin counter top with built-in washbasin
- ?? Hot and cold water, mixer tap, built-in showerhead
- ?? Shower drainage by gravity to waste water network
- ?? Hand-operated marine toilet
- ?? Bathroom accessories (toilet paper holder + towel rail)
- ?? Shelving above basin with mirror
- ?? Ventilation via 1 deck hatch
- ?? Lighting : 2 watertight spotlights

Forepeak :

- ?? Accessed through deck hatch
- ?? Painted in full, with gel-coat finish

ORCHESTRA VERSION: Owner's cabin – 3 guest cabins**PORT HULL : 1 owner's cabin + 1 guest cabin**

Staircase access to port hull.

Owner's cabin :

Accessed through wooden door in the passageway

Sleeping space :

- ?? Double bed 1.60/1.20x2.00 approx. with access on either side (island bed) and slatted bed base
- ?? 2 big drawers under the bed
- ?? 1 bedside table with shelving
- ?? Lots of cupboard space above the bed
- ?? Bookshelves above the bed
- ?? Ventilation via deck hatch
- ?? Blinds and mosquito nets on deck hatches
- ?? Large non-opening picture window, external view
- ?? Main lighting via 3 spotlights and 2 bedside reading lights

Saloon area :

- ?? Wooden desk with leather pad and space under lift-up front
- ?? Drawers under the desk
- ?? Lots of cupboard space and hanging space
- ?? 2 coat hooks
- ?? Ventilation via 2 deck hatches + 1 escape hatch overlooking underside of the pod
- ?? Blinds and mosquito nets on the deck hatches
- ?? Main lighting via halogen spotlights and 1 desk reading light

Bathroom space :

- ?? Access via wooden door in the owner's cabin
- ?? Synthetic resin counter top with built-in washbasin
- ?? Hot and cold water, mixer tap
- ?? Hand-operated marine toilet

- ?? Bathroom accessories (toilet paper holder + towel rail)
- ?? Big mirror above wash basin
- ?? Drainage by gravity to waste water network
- ?? Ventilation via 2 deck hatches
- ?? Lighting via 2 watertight spotlights

Fore cabin :

- ?? Access via wooden door in passageway
- ?? Double bed (1.35/1.10x2.00m approx.) with slatted bed base
- ?? 2 big drawers under the bed
- ?? 1 hanging space and cupboards
- ?? Ventilation via 2 deck hatches
- ?? Blinds and mosquito nets on the deck hatches
- ?? Main lighting via 2 halogen spotlights + 2 bedside reading lights

Forward bathroom :

- ?? Private access via wooden door in fore cabin
- ?? Synthetic resin counter top with built-in washbasin
- ?? Hot and cold water, mixer tap with built-in showerhead
- ?? Shower drainage by gravity to waste water network
- ?? Hand-operated marine toilet
- ?? Bathroom accessories (toilet paper holder + towel rail)
- ?? Shelving above washbasin with mirror
- ?? Ventilation via 1 deck hatch
- ?? 2 watertight spotlights

Forepeak :

- ?? Accessed by deck hatch
- ?? Painted in full, with gel-coat finish

STARBOARD HULL : 2 guest cabins

Staircase access to starboard hull

Aft cabin :

- ?? Accessed through wooden door in passageway
- ?? Double bed (1.60/1.20x2.00m approx.) accessible from either side (island bed) and slatted bed base
- ?? 2 big drawers under the bed
- ?? Lots of cupboard space and hanging space
- ?? 2 coat hooks
- ?? Ventilation via 2 deck hatches
- ?? Large non-opening picture window with external view
- ?? Large non-opening picture window, external view
- ?? Blinds and mosquito nets on deck hatches

Aft bathroom :

- ?? Private access via wooden door in the aft cabin
- ?? Synthetic resin counter top with built-in washbasin
- ?? Hot and cold water, mixer tap with built-in showerhead
- ?? Shower with drainage by gravity to waste water network
- ?? Hand-operated marine toilet
- ?? Bathroom accessories (toilet paper holder + towel rail)
- ?? Shelving above washbasin with mirror
- ?? Ventilation via deck hatch
- ?? 2 watertight spotlights

Passageway :

- ?? Storage volume 250 L cooled by 1 eutectic plaque
- ?? Eutectic plaque energy supplied via 1 refrigeration system
- ?? Refrigeration volume 450 L cooled by 1 eutectic plaque
- ?? Eutectic plaque energy supplied via 1 refrigeration system 12V/220V coupled indirectly to engine
- ?? Spacious cupboards with space for 5 kg washing machine and 5 kg clothes dryer
- ?? Escape hatch overlooking underside of the pod

Fore cabin :

- ?? Access via wooden door in passageway
- ?? Double bed (1.35/1.10x2.00m approx.) with slatted bed base
- ?? 2 big drawers under the bed
- ?? 1 hanging space and cupboards
- ?? Ventilation via 2 deck hatches
- ?? Blinds and mosquito nets on the deck hatches
- ?? Main lighting via 2 halogen spotlights + 2 bedside reading lights

Forward bathroom :

- ?? Private access via wooden door in fore cabin
- ?? Synthetic resin counter top with built-in washbasin
- ?? Hot and cold water, mixer tap with built-in showerhead
- ?? Shower drainage by gravity to waste water network
- ?? Hand-operated marine toilet
- ?? Bathroom accessories (toilet paper holder + towel rail)
- ?? Shelving above washbasin with mirror
- ?? Ventilation via 1 deck hatch
- ?? 2 watertight spotlights

Forepeak :

- ?? Accessed by deck hatch
- ?? Painted in full, with gel-coat finish

CONCERTO VERSION: Owner's cabin – 2 cabins with skipper

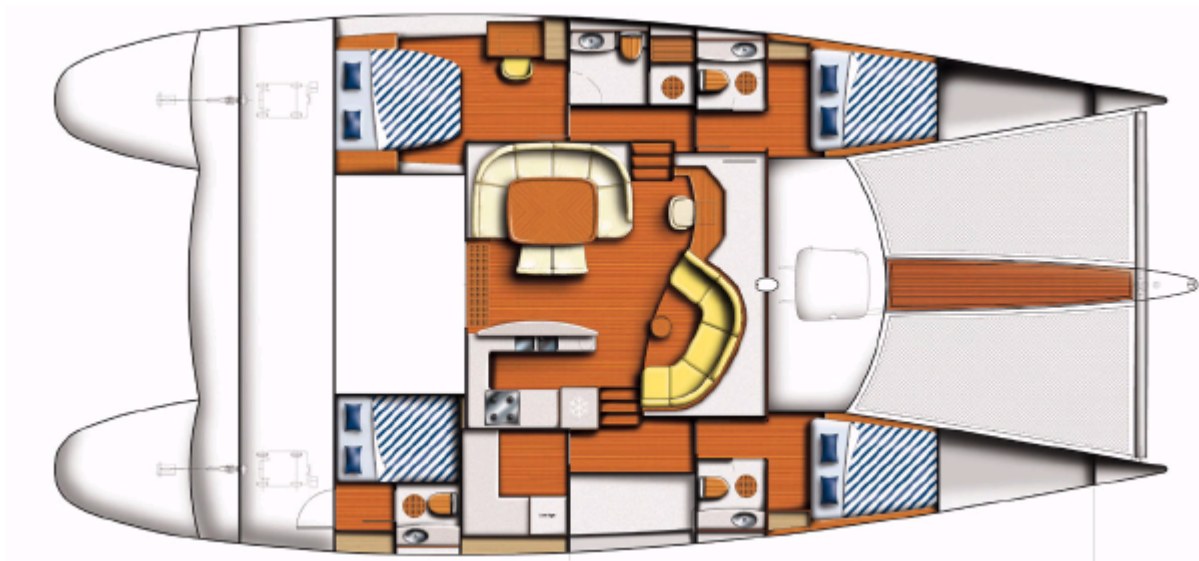

PORT HULL : 1 owner's cabin + 1 guest cabin

Stairway access to port hull.

Owner's cabin :

Access through wooden door in the passageway

Sleeping accommodation :

- ?? Double bed, 1.60 / 1.20 x 2.00 approx. with access from either side (island bed) and slatted bed base
- ?? 2 spacious drawers under the bed
- ?? 1 bedside table with shelves
- ?? Lots of cupboards above the bed
- ?? Bookcase above the bed
- ?? Ventilation via deck hatch
- ?? Blinds and mosquito netting on deck hatches
- ?? Large non-opening picture window, external view
- ?? Main lighting : 3 spotlights and 2 bedside reading lights

Saloon area :

- ?? Wooden desk with leather pad and space under lift-up front
- ?? Drawers under desk
- ?? Lots of cupboards and hanging space
- ?? 2 coat hooks
- ?? Ventilation via 2 deck hatches + 1 escape hatch overlooking underside of the pod
- ?? Blinds and mosquito nets on the deck hatches
- ?? Main lighting : halogen spotlights and 1 desk reading light

Bathroom area :

- ?? Accessed through wooden door in the owner's cabin
- ?? Synthetic resin counter top with built-in washbasin
- ?? Hot and cold water, mixer tap
- ?? Hand-operated marine toilet
- ?? Bathroom accessories (toilet paper holder + towel rail)
- ?? Big mirror above washbasin
- ?? Drainage by gravity to waste water network
- ?? Ventilation via 2 deck hatches
- ?? Watertight spotlight

Fore cabin :

- ?? Accessed through wooden door in the passageway
- ?? Double bed (1.35/1.10x2.00m approx.) with slatted bed base
- ?? 2 big drawers under the bed
- ?? 1 hanging space and storage space
- ?? Ventilation via 2 deck hatches
- ?? Blinds and mosquito nets on the deck hatches
- ?? Main lighting via 2 halogen spotlights + 2 bedside reading lights

Forward bathroom :

- ?? Private access from the cabin via wooden door
- ?? Synthetic resin counter top with built-in washbasin
- ?? Hot and cold water, mixer tap, built-in showerhead
- ?? Shower drainage by gravity to waste water network
- ?? Hand-operated marine toilet
- ?? Bathroom accessories (toilet paper holder + towel rail)
- ?? Shelving above basin with mirror
- ?? Ventilation via 1 deck hatch
- ?? Lighting : 2 watertight spotlights

Forepeak :

- ?? Accessed through deck hatch
- ?? Painted in full, with gel-coat finish

STARBOARD HULL : 1 skipper's cabin + 1 guest cabin + clothes washing area**Skipper's cabin :**

- ?? Accessed through deck hatch and ladder
- ?? Double bed (1.40x2.00 m approx.)
- ?? Spacious cupboard under the bed

Skipper's bathroom :

- ?? Private access through wooden door in skipper's cabin
- ?? Synthetic resin counter top with built-in washbasin
- ?? Hot and cold water, mixer tap with built-in showerhead
- ?? Shower with drainage by gravity to waste water network
- ?? Hand-operated marine toilet
- ?? Bathroom accessories (toilet paper holder + towel rail)
- ?? Big mirror above wash basin
- ?? Ventilation via 1 deck hatch
- ?? 2 watertight spotlights

Passageway :

- ?? Storage volume 250 L cooled by 1 eutectic plaque
- ?? Eutectic plaque energy supplied via 1 refrigeration system
- ?? Refrigeration volume 450 L cooled by 1 eutectic plaque
- ?? Eutectic plaque energy supplied via 1 refrigeration system 12V/220V coupled indirectly to engine
- ?? Spacious cupboards

Clothes washing area :

- ?? Accessed through wooden door in passageway
- ?? L-shaped working top
- ?? Lots of cupboard space
- ?? Space for 5 kg washing machine and 5 kg clothes dryer

Fore cabin :

- ?? Accessed through wooden door in the passageway
- ?? Double bed (1.35/1.10x2.00m approx.) with slatted bed base
- ?? 2 big drawers under the bed
- ?? 1 hanging space and storage space
- ?? Ventilation via 2 deck hatches
- ?? Blinds and mosquito nets on the deck hatches
- ?? Main lighting via 2 halogen spotlights + 2 bedside reading lights

Forward bathroom :

- ?? Private access from the cabin via wooden door
- ?? Synthetic resin counter top with built-in washbasin
- ?? Hot and cold water, mixer tap, built-in showerhead
- ?? Shower drainage by gravity to waste water network
- ?? Hand-operated marine toilet
- ?? Bathroom accessories (toilet paper holder + towel rail)
- ?? Shelving above basin with mirror
- ?? Ventilation via 1 deck hatch
- ?? Lighting : 2 watertight spotlights

Forepeak :

- ?? Accessed through deck hatch
- ?? Painted in full, with gel-coat finish

QUATUOR VERSION: 4 double cabins**PORT HULL : 2 double cabins**

Stairway access to port hull.

Aft cabin :

- ?? Accessed through wooden door in passageway
- ?? Double bed (1.60/1.20x2.00m approx.) accessible from either side (island bed) and slatted bed base
- ?? 2 big drawers under the bed
- ?? Lots of cupboard space and hanging space
- ?? Ventilation via 2 deck hatches
- ?? Large non-opening picture window with external view
- ?? Blinds and mosquito nets on deck hatches
- ?? Main lighting via 3 halogen spotlights and 2 bedside reading lights

Aft bathroom :

- ?? Private access via wooden door in the aft cabin
- ?? Synthetic resin counter top with built-in washbasin
- ?? Hot and cold water, mixer tap with built-in showerhead
- ?? Shower with drainage by gravity to waste water network
- ?? Hand-operated marine toilet
- ?? Bathroom accessories (toilet paper holder + towel rail)
- ?? Shelving above washbasin with mirror
- ?? Ventilation via deck hatch
- ?? 2 watertight spotlights

Passageway :

- ?? Set of cupboards

Fore cabin :

- ?? Access via wooden door in passageway
- ?? Double bed (1.35/1.10x2.00m approx.) with slatted bed base
- ?? 2 big drawers under the bed
- ?? 1 hanging space
- ?? Ventilation via 2 deck hatches + 1 interior porthole
- ?? Blinds and mosquito net on the deck hatches
- ?? Main lighting via 2 halogen spotlights and 2 bedside reading lights

Forward bathroom :

- ?? Private access via wooden door in fore cabin
- ?? Synthetic resin counter top with built-in washbasin
- ?? Hot and cold water, mixer tap with built-in showerhead
- ?? Shower drainage by gravity to waste water network
- ?? Hand-operated marine toilet
- ?? Bathroom accessories (toilet paper holder + towel rail)
- ?? Shelving above washbasin with mirror
- ?? Ventilation via 1 deck hatch
- ?? 2 watertight spotlights

Forepeak :

- ?? Accessed by deck hatch
- ?? Painted in full, with gel-coat finish

STARBOARD HULL : 2 guest cabins

Stairway access to starboard hull.

Aft cabin :

- ?? Accessed through wooden door in passageway
- ?? Double bed (1.60/1.20x2.00m approx.) accessible from either side (island bed) and slatted bed base
- ?? 2 big drawers under the bed
- ?? Lots of cupboard space and hanging space
- ?? 2 coat hooks
- ?? Ventilation via 2 deck hatches
- ?? Large non-opening picture window with external view
- ?? Blinds and mosquito nets on deck hatches
- ?? Main lighting via 3 spotlights and 2 bedside reading lights

Aft bathroom :

- ?? Private access via wooden door in the aft cabin
- ?? Synthetic resin counter top with built-in washbasin
- ?? Hot and cold water, mixer tap with built-in showerhead
- ?? Shower with drainage by gravity to waste water network
- ?? Hand-operated marine toilet
- ?? Bathroom accessories (toilet paper holder + towel rail)
- ?? Shelving above washbasin with mirror
- ?? Ventilation via deck hatch
- ?? 2 watertight spotlights

Passageway :

- ?? Storage volume 250 L cooled by 1 eutectic plaque
- ?? Eutectic plaque energy supplied via 1 refrigeration system
- ?? Refrigeration volume 450 L cooled by 1 eutectic plaque
- ?? Eutectic plaque energy supplied via 1 refrigeration system 12V/220V coupled indirectly to engine
- ?? Spacious cupboards with space for 5 kg washing machine and 5 kg clothes dryer

Fore cabin :

- ?? Access via wooden door in passageway
- ?? Double bed (1.35/1.10x2.00m approx.) with slatted bed base
- ?? 2 big drawers under the bed
- ?? 1 hanging space and cupboards
- ?? Ventilation via 2 deck hatches
- ?? Blinds and mosquito nets on the deck hatches
- ?? Main lighting via 2 halogen spotlights + 2 bedside reading lights

Forward bathroom :

- ?? Private access via wooden door in fore cabin
- ?? Synthetic resin counter top with built-in washbasin
- ?? Hot and cold water, mixer tap with built-in showerhead
- ?? Shower drainage by gravity to waste water network
- ?? Hand-operated marine toilet
- ?? Bathroom accessories (toilet paper holder + towel rail)
- ?? Shelving above washbasin with mirror
- ?? Ventilation via 1 deck hatch
- ?? 2 watertight spotlights

Forepeak :

- ?? Accessed by deck hatch
- ?? Painted in full, with gel-coat finish

QUINTET VERSION: 4 double cabins with skipper**PORT HULL : 1 skipper's cabin + 2 double cabins**

Staircase access to port hull.

Skipper's cabin :

- ?? Accessed through deck hatch and ladder
- ?? Double bed (1.40x2.00 m approx.)
- ?? Spacious cupboard under the bed

Skipper's bathroom :

- ?? Private access through wooden door in skipper's cabin
- ?? Synthetic resin counter top with built-in washbasin
- ?? Hot and cold water, mixer tap with built-in showerhead
- ?? Shower with drainage by gravity to waste water network
- ?? Hand-operated marine toilet
- ?? Bathroom accessories (toilet paper holder + towel rail)
- ?? Big mirror above wash basin
- ?? Ventilation via 1 deck hatch
- ?? 2 watertight spotlights

Aft cabin :

- ?? Accessed via wooden door in the passageway
- ?? 2 twin beds (0.70x2.00m approx.) with slatted bed base
- ?? 1 big drawer under each bed
- ?? Hanging space and cupboards
- ?? Ventilation via 2 deck hatches
- ?? Blinds and mosquito nets on the deck hatches
- ?? Main lighting via 3 spotlights and 2 bedside reading lights

Aft bathroom :

- ?? Private access via wooden door in the aft cabin
- ?? Synthetic resin counter top with built-in washbasin
- ?? Hot and cold water, mixer tap with built-in showerhead
- ?? Shower with drainage by gravity to waste water network
- ?? Hand-operated marine toilet
- ?? Bathroom accessories (toilet paper holder + towel rail)
- ?? Shelving above washbasin with mirror
- ?? Ventilation via deck hatch
- ?? 2 watertight spotlights

Fore cabin :

- ?? Access via wooden door in passageway
- ?? Double bed (1.35/1.10x2.00m approx.) with slatted bed base
- ?? 2 big drawers under the bed
- ?? 1 hanging space and cupboards
- ?? Ventilation via 2 deck hatches
- ?? Blinds and mosquito nets on the deck hatches
- ?? Main lighting via 2 halogen spotlights + 2 bedside reading lights

Forward bathroom :

- ?? Private access via wooden door in fore cabin
- ?? Synthetic resin counter top with built-in washbasin
- ?? Hot and cold water, mixer tap with built-in showerhead
- ?? Shower drainage by gravity to waste water network
- ?? Hand-operated marine toilet
- ?? Bathroom accessories (toilet paper holder + towel rail)
- ?? Shelving above washbasin with mirror
- ?? Ventilation via 1 deck hatch
- ?? 2 watertight spotlights

Forepeak :

- ?? Accessed by deck hatch
- ?? Painted in full, with gel-coat finish

STARBOARD HULL : 2 guest cabins

Staircase access to starboard hull.

Aft cabin :

- ?? Access via wooden door in the passageway
- ?? Double bed (1.60 / 1.20 x 2.00m approx.) with access from either side (island bed) and slatted bed base
- ?? 2 spacious drawers under the bed
- ?? Lots of cupboards and hanging space
- ?? 2 coat hooks
- ?? Ventilation via 2 deck hatches
- ?? Large non-opening picture window, external view
- ?? Blinds and mosquito netting on deck hatches
- ?? Main lighting : 3 spotlights and 2 bedside reading lights

Aft bathroom :

- ?? Private access through wooden door from the aft cabin
- ?? Synthetic resin counter top with built in wash basin
- ?? Hot and cold water, mixer tap, built in hand shower
- ?? Shower with drainage to waste water network
- ?? Hand-operated marine toilet
- ?? Bathroom accessories (toilet paper holder and + towel rail)
- ?? Shelving above basin with mirror
- ?? Ventilation via 1 deck hatch
- ?? Lighting : 2 watertight spotlights

Passageway :

- ?? Storage volume 250 L cooled by 1 eutectic plaque
- ?? Eutectic plaque energy supplied via 1 refrigeration system
- ?? Refrigeration volume 450 L cooled by 1 eutectic plaque
- ?? Eutectic plaque energy supplied via 1 refrigeration system 12V/220V coupled indirectly to engine
- ?? Spacious cupboards with space for 5 kg washing machine and 5 kg clothes dryer

Fore cabin :

- ?? Accessed through wooden door in the passageway
- ?? Double bed (1.35/1.10x2.00m approx.) with slatted bed base
- ?? 2 big drawers under the bed
- ?? 1 hanging space and storage space
- ?? Ventilation via 2 deck hatches
- ?? Blinds and mosquito nets on the deck hatches
- ?? Main lighting via 2 halogen spotlights + 2 bedside reading lights

Forward bathroom :

- ?? Private access from the cabin via wooden door
- ?? Synthetic resin counter top with built-in washbasin
- ?? Hot and cold water, mixer tap, built-in showerhead
- ?? Shower drainage by gravity to waste water network
- ?? Hand-operated marine toilet
- ?? Bathroom accessories (toilet paper holder + towel rail)
- ?? Shelving above basin with mirror
- ?? Ventilation via 1 deck hatch
- ?? Lighting : 2 watertight spotlights

Forepeak :

- ?? Accessed through deck hatch
- ?? Painted in full, with gel-coat finish

DECK LAYOUT :**Helming station :**

- ?? Double helmsman seat
- ?? Large instrument control panel
- ?? Altuglas protective windshield

Cockpit :

- ?? 1 « comfy » 3-person bench seat + 1 « comfy » 4-person bench seat, teak battens
- ?? 1 fixed teak batten cockpit table
- ?? 1 teak batten 6-person bench seat + 1 teak batten 2-person bench seat around the table + 2 fauteuils
- ?? 1 locker in cockpit floor
- ?? 2 very big lockers behind the 6-person bench seat with space to put a gas bottle
- ?? 2 lockers for liferaft with direct access to the sea

Foredeck area :

- ?? 1 big fore locker separated into 3 compartments (2 for mooring gear) with storage space for the mast for halyards at the foot of the mast
- ?? Polyester locker cover on jack

2 technical holds aft :

- ?? Accessed through polyester locker cover on jack in the cockpit
- ?? Foredeck area with large reception panel for electrical equipment
- ?? Aft area with space for generator, air-conditioning unit, water maker, compressor for scuba diving tanks...
- ?? 2 neon lights

2 engine holds :

- ?? independent engine compartment under floor on foredeck area
- ?? access via 2 hinged panels
- ?? high-performance sound proofing
- ?? 1 neon light

ENGINES :**Engines and equipment :**

- ?? 2 x 75 Hp engines
- ?? High-resistance stainless steel direct transmission shafts
- ?? V-shaped shaft bearing bracket
- ?? 2 three-blade fixed propeller
- ?? Salt water filters
- ?? Engine cooled by exchanger
- ?? Engine compartment ventilation natural intake of air + mechanical extraction of air
- ?? Complete control panels and dual engine controls at helming station
- ?? Engine hour meter

Diesel circuit :

- ?? 1 x 600 L aluminum diesel tank filled directly via the locker in the cockpit floor
- ?? Electrical gauge with indicator at chart table
- ?? 1 diesel pre-filter water separator + engine diesel filter
- ?? Diesel shut-off valve accessible via the locker in the cockpit floor

PLUMBING :

- ?? Polypropylene freshwater tanks (3x275 L approx.) with 1 electric gauge (indicator at chart table)
- ?? Twin electrical pump and pressure ball
- ?? Dockside intake for direct connection to fresh water supply
- ?? Rainwater collected on the roof
- ?? 2 x 40 L water heater
- ?? 1 electrical bilge pump (3,8 m3/h) in each engine hold
- ?? 1 independent electrical bilge pump (2 m3/h) in each float
- ?? 4 x automatically starting bilge pumps with audible and visual alarm at the chart table
- ?? 1 hand-operated external drying out pump
- ?? 1 dirty water collector in each float
- ?? 2 x pump to drain away waste water with automatic or manual control (possible to use both pumps as bilge pumps)

ELECTRICITY / ELECTRONICS :**Power circuit :**

- ?? 1 port engine battery 100 Ah 12V + 1 starboard engine battery 100 Ah 12V
- ?? 2 engine alternators 80 Ah 12V recharging these 2 engine batteries
- ?? Back-up manual connection between both sets of engine batteries
- ?? 1 set of batteries for on board energy supply to port 320 Ah 24V + 1 set of batteries for on board energy supply to starboard 320 Ah 24V
- ?? 2 engine alternators 75 A 24V with high-performance adjustments recharging both sets of batteries for the energy supply on board
- ?? Back-up manual connection between both sets of on board batteries
- ?? Overall circuit protection via trip switch

Distribution 24V :

- ?? Distribution decentralized from the 24V functions
- ?? Protection via trip switches located in 5 watertight lockers
- ?? 12V switchboard at the chart table protected by trip switches for the electronics and navigational lights
- ?? Free starts for other equipment

Electronics :

- ?? 1 complete navigation unit including, log, speedo, sounder, masthead fly and anemometer
- ?? 1 V.H.F. masthead aerial
- ?? 1 x 24V hydraulic pump for the automatic helm

RIGGING AND SAILS :**Mast and boom :**

- ?? White lacquered aluminum mast and boom
- ?? Full standing rigging
- ?? Ball bearing slides on mainsail luff
- ?? 1 mainsail halyard, twin-thread low-stretch cover
- ?? 1 genoa halyard
- ?? 1 spinnaker halyard
- ?? 1 boom topping lift
- ?? 3 reefing pendant
- ?? 2 lazy-jacks
- ?? 2 flag halyards
- ?? Jammers of all halyards, reefing pendants and topping lift
- ?? 1 electric size 46 self-tailing winch for mainsail halyard and reefing pendants, 1 size 44 self-tailing winch for genoa/spinnaker halyards
- ?? Lights for headway under sail, under engine power and mooring lights
- ?? Deck lighting

Sails

- ?? Fully-battened mainsail and very high quality genoa jib
- ?? Genoa roller furler

DECK GEAR :**Mainsail and genoa jib :**

- ?? 1 mainsheet tackle with lead aft the cockpit
- ?? 2 jammers for mainsheet
- ?? 2 size 56 winches for mainsheet
- ?? 1 mainsail ball-bearing sheet traveler
- ?? 2 x traveler trimming tackle on jammers
- ?? Genoa sheet track traveler with lead block
- ?? 2 genoa sheets
- ?? 2 x size 64 winch for geneoa

Other equipment :

- ?? Hydraulic helming system with leather covered steering wheel helm
- ?? 1 back-up tiller
- ?? 1 steering compass
- ?? 3 winch handles + 3 pockets
- ?? Pushpits and pulpits, stanchions with upper and lower guardrails
- ?? 2 Swedish pulpits
- ?? Cockpit accessed gangway pushpits
- ?? Teak battened aft skirt lower platform
- ?? 1 swim ladder + 1 cold water shower in the port skirt
- ?? 2 tender davits (300 kg max. load each) with jammers
- ?? 1 size 16 self-tailing winch on starboard davit
- ?? 7 mooring cleats (2 foredeck + 2 midships + 2 aft + 1 anchor locker)
- ?? 1500 W electric windlass protected by trip switch
- ?? Anchor exit under the pod with built-in two-part sling
- ?? Fore beam in white lacquered aluminum
- ?? Polyester catwalk with teak battens incorporating the jib boom
- ?? Anchor accessed via teak deck hatch under the catwalk
- ?? 1 mooring davit on fore beam
- ?? 2 nets forwards + 2 Bathyline overnets
- ?? Kit of spare parts
- ?? 2 layers of anti-fouling
- ??

STANDARD MANUFACTURERS USED :

- Engines : YANMAR
- Deck hatches and portholes : GOÏOT
- Mast : Z. DIFFUSION
- Sails : INCIDENCES
- Rollers : PROENGIN
- Winches, blocks, tracks and traveler cars : HARKEN
- Jammers : SPINLOCK
- Windlass : LOFRANS'
- Refrigeration systems : INDEL and C.L.D.
- Oven and cooking hob : DE DIETRICH
- Navigational unit : AUTOHELM

All dimensions are provided by way of indication only.